

# Terminal Expansion Project Phase Overview

## Level 0

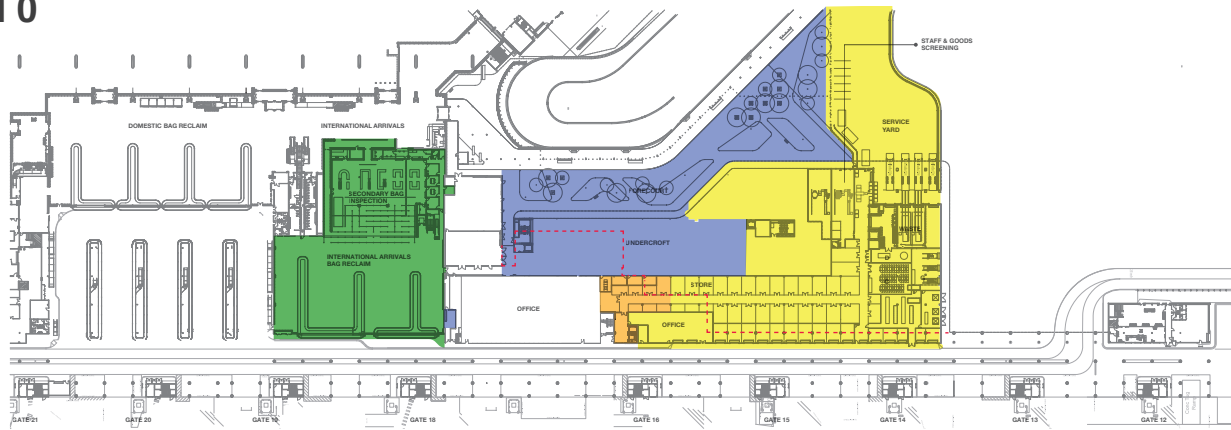

## Level 1

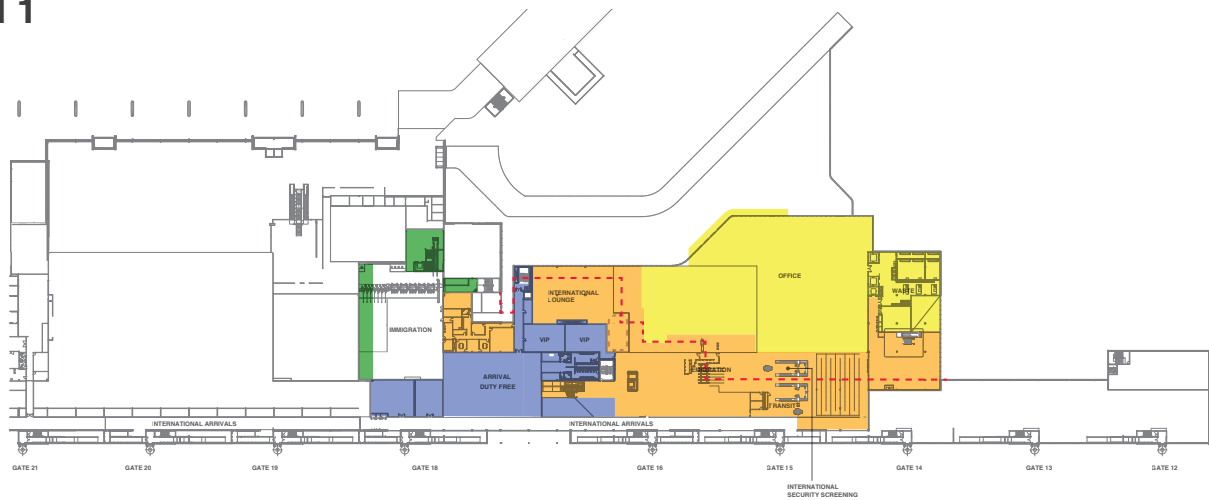

## Level 2

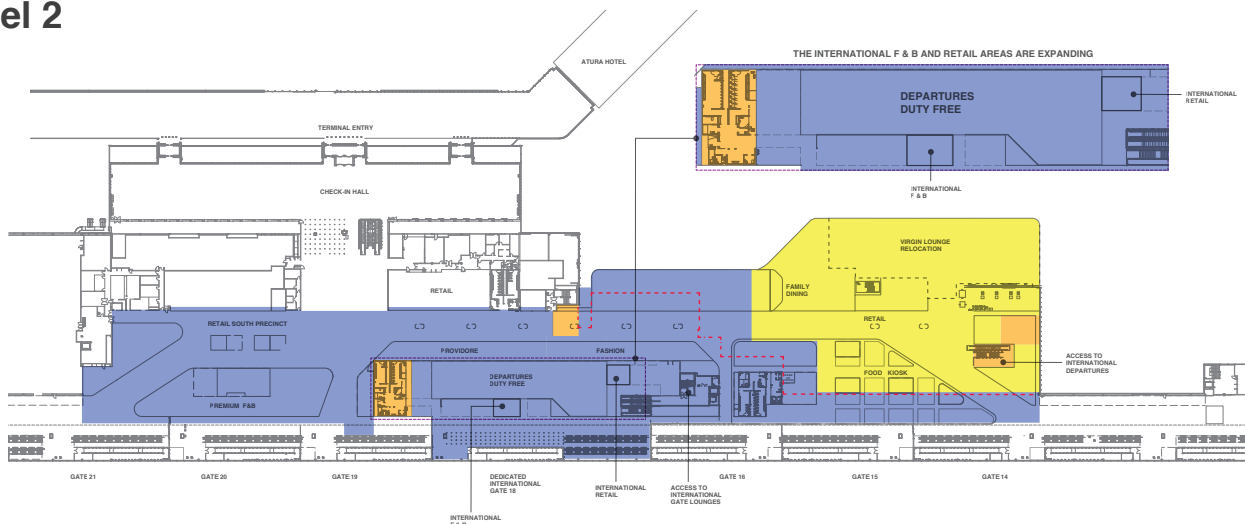

CURRENT BUILDING FOOTPRINT - - - - -

DETAILS OVERLEAF →

Timeline

Phase 1 & 2

Phase 3

Phase 4

Phase 5

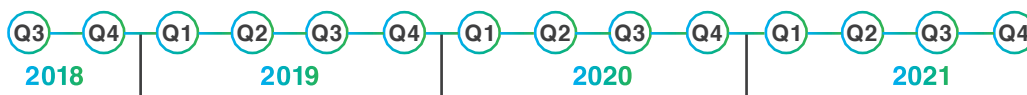

**Terminal  
Expansion  
Project**

## Terminal Expansion Project: Summary of works

Phases	Phase Description:	Key Works Summary Description:	Impacts:	Result:
18/6/2018 to 20/7/2020	Site Establishment	Site Mobilisation	Traffic via Export Park	Site compound established
<b>Phase 1 &amp; 2</b> Q3 2018 to Q1 2020	New expanded building footprint area to north of Terminal	<p><b>L00</b></p> <ul style="list-style-type: none"> <li>Undercroft (part)</li> <li>Northern Plant Rooms</li> <li>Northern Screening</li> <li>Goods &amp; Staff Screening</li> <li>Waste Management &amp; Service Yard</li> <li>Storage / Airside Offices areas</li> <li>Virgin Australia Engineering Relocation</li> </ul> <p><b>L01</b></p> <ul style="list-style-type: none"> <li>Border Agency Offices (part) Level 01</li> <li>Commercial Offices</li> </ul> <p><b>L02</b></p> <ul style="list-style-type: none"> <li>Virgin Australia Lounge Relocation</li> <li>Northern Retail Concourse areas and associated Retail tenancies (base building)</li> </ul>	<ul style="list-style-type: none"> <li>Changes to Terminal concourse access during construction works adjacent to Gate 16 / 15</li> <li>Modified external pedestrian access to the Terminal around the construction site</li> <li>Modification to the Airside road access at northern end around Gates 16 / 15 / 14</li> </ul>	<ul style="list-style-type: none"> <li>Virgin Australia Lounge &amp; Engineering relocation</li> <li>Border Agency relocation to new L01 Offices (part)</li> <li>New Retail precinct open (part) to northern end</li> <li>New Northern Screening / Service Yard available</li> <li>Decanting of existing Aviation House tenants</li> </ul>
<b>Phase 3</b> Q4 2019 to Q4 2020	International Arrival expansion & upgrades to L00 & L01 areas	<p><b>L00</b></p> <ul style="list-style-type: none"> <li>Existing Baggage belt extension and second belt addition</li> <li>Upgrade of Secondary Examination Area (SEA)</li> </ul> <p><b>L01</b></p> <ul style="list-style-type: none"> <li>Stairs and vertical transportation from Immigration to International Baggage claim area at L00</li> <li>Expansion of International Arrivals inbound Immigration</li> </ul>	<ul style="list-style-type: none"> <li>Changes to passenger flows for International Arrivals through Immigration and Baggage claim areas</li> <li>Changes to the Border Force operations adjacent Immigration</li> <li>Aviation House demolition</li> </ul>	<ul style="list-style-type: none"> <li>Staged works in discrete zones to enable ongoing International Arrival operations to be maintained</li> <li>Progressive relocation of Border Force Offices, Immigration and International Baggage Reclaim</li> <li>Improved facilitation for inbound International passengers</li> </ul>
<b>Phase 4</b> Q2 2019 to Q1 2021	International Departures expansion including new LAGS and Emigration	<p><b>L01</b></p> <ul style="list-style-type: none"> <li>International &amp; VIP Lounges</li> <li>Border Agency Offices (complete)</li> <li>Emigration and LAGS expansion</li> <li>Outbound Duty Free expansion (partial)</li> </ul>	<p><b>L01</b></p> <ul style="list-style-type: none"> <li>Relocate existing International Lounge and Border Agency Offices refurbishment</li> <li>Relocate existing Emigration and LAGS from L02 to L01</li> </ul>	<ul style="list-style-type: none"> <li>Staged works in discrete zones to enable ongoing Terminal operation to be maintained</li> <li>Complete consolidation of Border Agency Offices</li> <li>International Departures process commences from new L01 area</li> </ul>
<b>Phase 5</b> Q4 2020 to Q2 2021	Completion of Retail Concourse Refurbishment	<ul style="list-style-type: none"> <li>Balance of L02 concourse Retail &amp; amenities</li> <li>Outbound &amp; Inbound Duty Free expansion (complete)</li> <li>Baggage Service Room</li> <li>Undercroft (complete)</li> <li>Forecourt</li> </ul>	<ul style="list-style-type: none"> <li>PAX flows through to immigration, Emigration and concourse</li> <li>Working adjacent international lounge</li> </ul>	<ul style="list-style-type: none"> <li>Stage works in discrete zones to enable ongoing operation</li> <li>Detail coordination of Hoarding plans to mitigate disruption</li> <li>Performance of work at night, low PAX times</li> <li>Potential for earlier staging to mitigate mobilisations</li> </ul>

Roadmap to our future.  
Blueprint for our vision.



**Terminal  
Expansion  
Project**